

## Lifting Point Powertex LPS

### Product information



The Powertex LPS with swivel eye redefines the capabilities of traditional lifting points. Engineered for demanding industrial environments that require reliability and efficiency, the Powertex LPS has a dynamic **360-degree rotation feature** and an impressive 4.5 times increase in Working Load Limit (WLL) compared to conventional DIN580 lifting points. Its design incorporates a robust forged swivel eye, complemented by a bolt and washer assembly, which ensures secure and versatile lifting operations. The bolt features a hex socket cap grip for easy installation, allowing for swift mounting with standard tools. It includes a supplementary 'quick key' for manual tightening during temporary setups.

#### Allowed loading directions:

- Straight (max WLL)
- Sideways (not perpendicular to the eye)
- 180 degrees in the plane of the eye (+/- 90 degrees from centre line)

#### Product Features:

**Durable finish:** Coated in PURE RED powder paint, the Powertex LPS lifting points are visually distinct and offer superior resistance to wear and corrosion.

**Compliance to standard:** Manufactured to meet the testing requirements specified by EN 1677-1 and AS 3776, ensuring high safety and quality standards.

**Reliable:** Designed with a safety factor of at least 4 in the intended load directions, offering a secure lifting experience.

**Quality assurance:** Each component undergoes crack detection testing in the factory and forged links are proof load tested to ensure reliability.

**Type testing:** Each model undergoes factory type testing including breaking tests and fatigue test to 20,000 cycles at 1.5 times the WLL, highlighting the product's endurance.

... [Read more](#)

**Features:** 360 degrees rotatable

**Material:** Forged alloy steel

**Marking:** According to standard, CE-marked, UKCA-marked, POWERTEX or PX, model name, WLL and batch number

**Temperature range:** -40°C up to +200°C

**Finish:** Powder painted in PURE RED

**Standard:** EN 1677-1

**Note:** Before use, review the WLL diagram to select the correct LPS for your application

**Safety factor:** 4:1

## Lifting Point Powertex LPS

### Blueprint

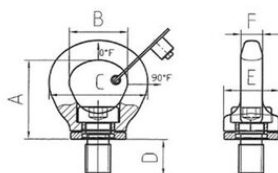

### Technical data

Part Code	WLL ton	Thread	Model	Torque Nm	A mm	B mm	C mm	D mm	E mm	F mm	Weight (kg)
4215LPSM8	0.3	M8	LPS-M8	6-10	38	26	45.3	11.5	25	8	0.11
4215LPSM10	0.4	M10	LPS-M10	6-10	38	26	45.3	14	25	8	0.12
4215LPSM12	0.75	M12	LPS-M12	10-15	43.5	32	54	17	33	10	0.2
4215LPSM16	1.5	M16	LPS-M16	20-30	52	37.5	63.5	24	36	14	0.35
4215LPSM20	2.3	M20	LPS-M20	50-70	63	44.5	78.5	30	47.5	20.6	0.66
4215LPSM24	3.2	M24	LPS-M24	120-150	74	51.6	92	35.3	53	20	1.1
4215LPSM30	4.5	M30	LPS-M30	200-250	92	65	118	45	68	24	2.1
4215LPSM36	7	M36	LPS-M36	280-400	105	76	136	56.8	82	30	4
4215LPSM42	9	M42	LPS-M42	400-500	121.5	88	160	66.5	92	35	5.5
4215LPSM48	12	M48	LPS-M48	400-500	138	100	180	75.5	110	42	8.9