

## Dee Shackle with Screw Pin

---

### Product information



Dee shackle with screw collar pin for quick and easy opening.

- Manufactured and tested in accordance with AS2741.
- All bodies are marked with the batch number for traceability.
- All parts are hot dip galvanized for long life.
- Test and mill certificates available on request.

... [Read more](#)

---

**Material:** Forged alloy steel

**Marking:** CE-marked

**Temperature range:** -10°C up to +200°C

**Finish:** Hot dip Galvanised with blue painted pins

**Safety factor:** 6:1

**Grade:** 6

## Dee Shackle with Screw Pin

### Blueprint

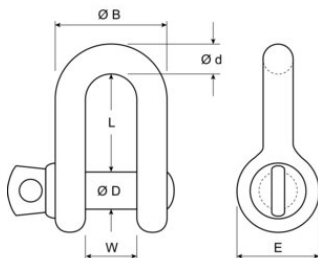

### Technical data

Part Code	WLL ton	d mm	D mm	W mm	L mm	E mm	Weight (kg)
420100011172	0.05	6	8	12	22	17	0.04
420100081170	0.75	8	10	1	26	21	0.076
420100101170	1	10	11	17	32	25	0.14
420100151170	1.5	11	13	18	37	27	0.18
420100201170	2	13	16	21	41	33	0.28
420100331170	3.25	16	19	27	51	40	0.54
420100481170	4.75	19	22	32	60	48	0.9
420100651170	6.5	22	25	37	71	54	1.4
420100851170	8.5	25	29	43	81	60	2.1
420100951170	9.5	29	32	46	90	67	2.9
420101201170	12	32	35	52	100	76	4
420101351170	13.5	35	38	57	113	84	5.4
420101701170	17	38	41	60	124	92	7